

Window Surround G.A. (WG03, WG04)

- Notes
1. All stone cast to BS1217: 2008 and the UKCSA Specification For Cast Stone.
 2. Minimum 35MPa compressive strength (when tested to BS1881: part 116).
 3. All details shown on this drawing are copyright protected and must not be copied or conveyed to any third party without express written consent.
 4. Lifting inserts and other fixings only included where specified.

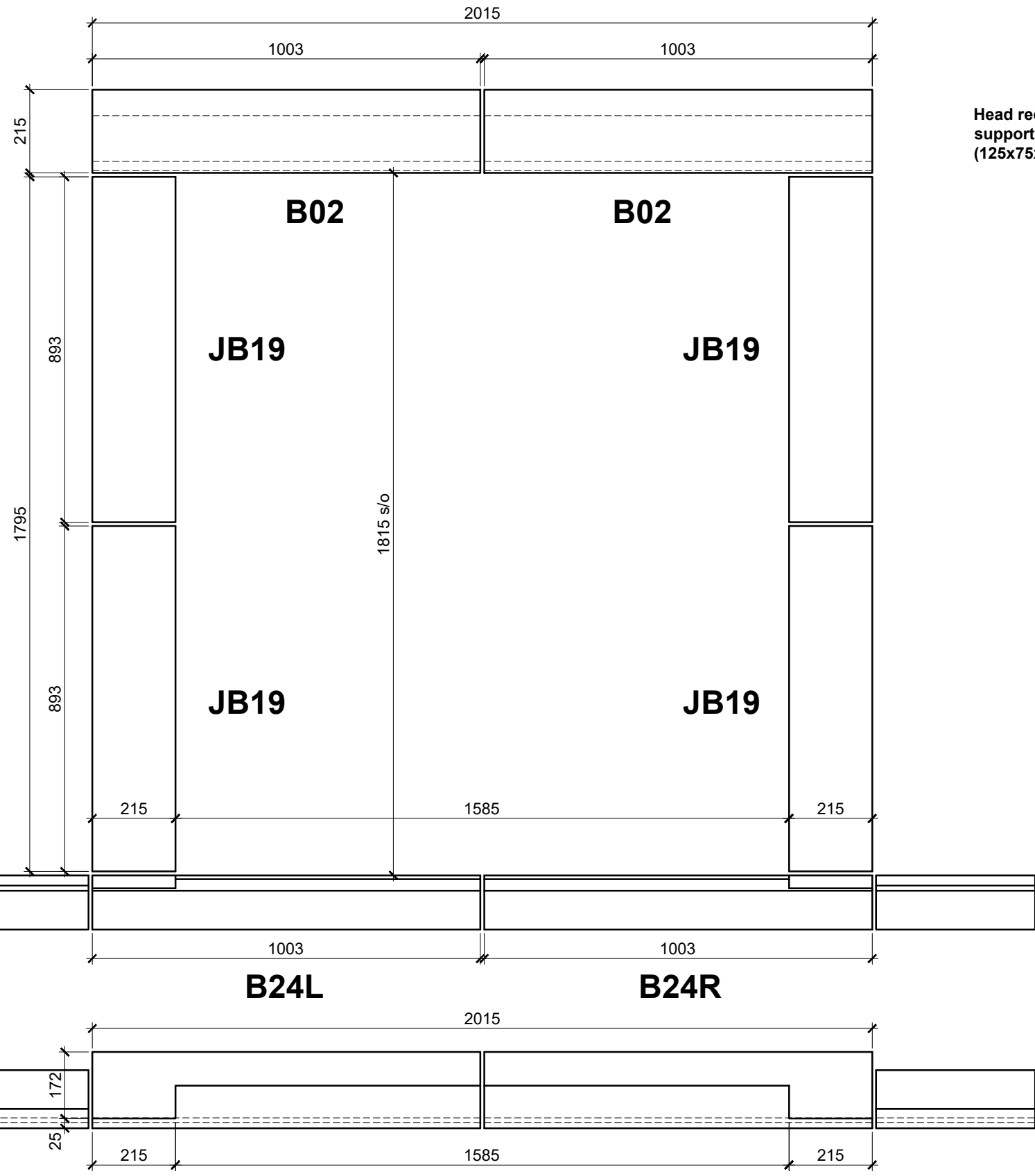

Plan View
Unit Ref: B24LT25068A (46kg)

Plan View
Unit Ref: B24RT25068B (46kg)

Head requires support below (125x75x10 RSA)

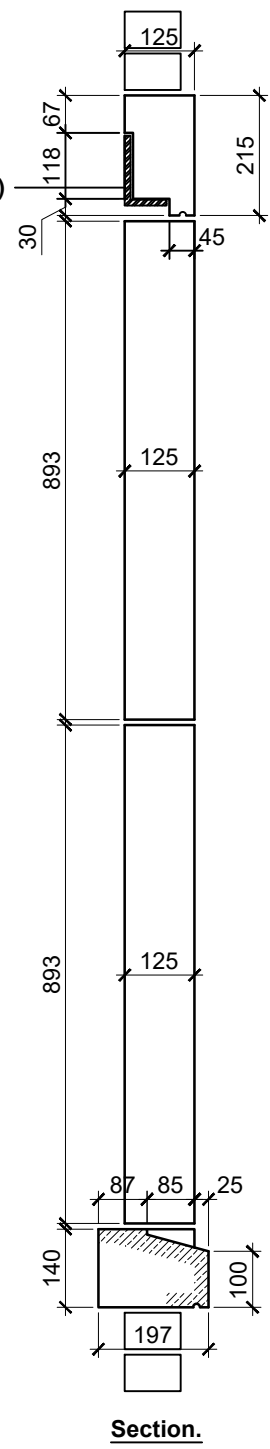

Section.

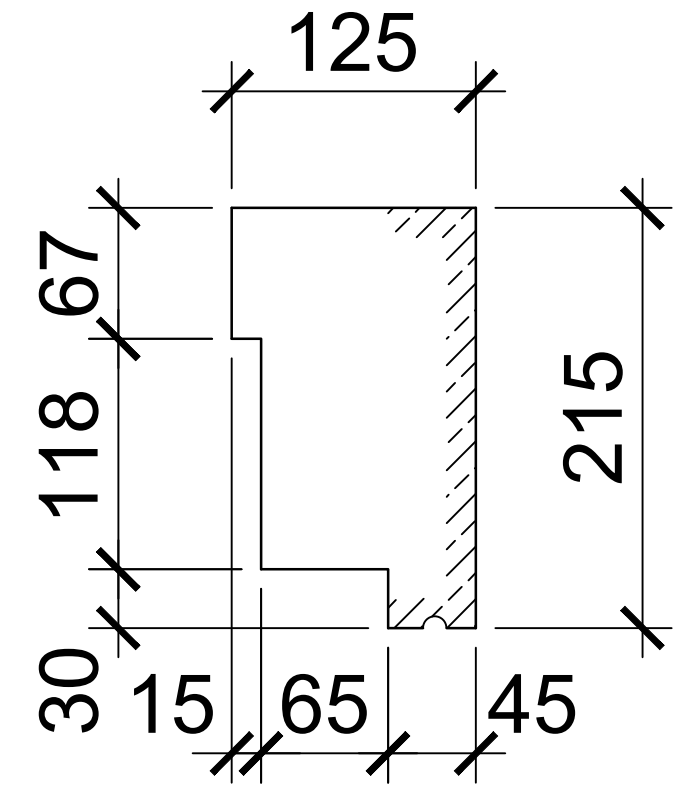

Section.

Rev	Date	Comments
A	15-06-21	Rebate added to head detail.
B	20-07-21	Rebate amended & drip added.
C	28-07-21	Jamb height increased.

Tel : 01302 729277
Fax : 01302 729288
www.penninestone.co.uk

PENNINE
STONE LIMITED

A HADDONSTONE Group Company

Site Details
THAMES & NEWCASTLE LTD.
16 Roehampton Gate, London.

Drg Title
Bespoke Window Surround.
Product: TecCast.

Date: 27/05/21	Drg No.
Scale: NTS	25068-12
Drawn By: M. Brakewell	Rev. C