

Chimney Capping Detail.

- Notes
- 1. All stone cast to BS1217: 2008 and the UKCSA Specification For Cast Stone.
 - 2. Minimum 35MPa compressive strength (when tested to BS1881: part 116).
 - 3. All details shown on this drawing are copyright protected and must not be copied or conveyed to any third party without express written consent.
 - 4. Lifting inserts and other fixings only included where specified.

Elevation View.

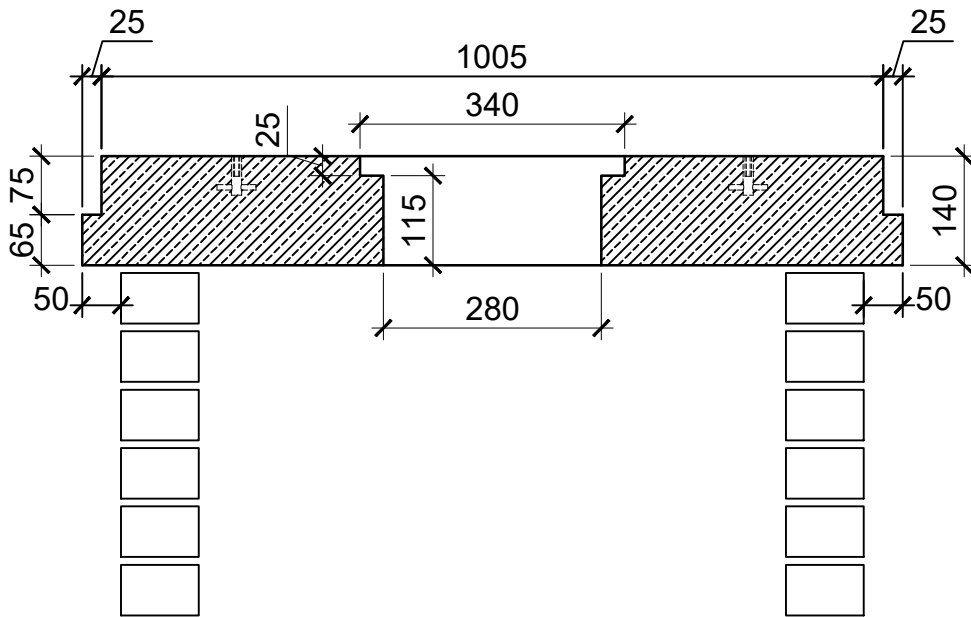
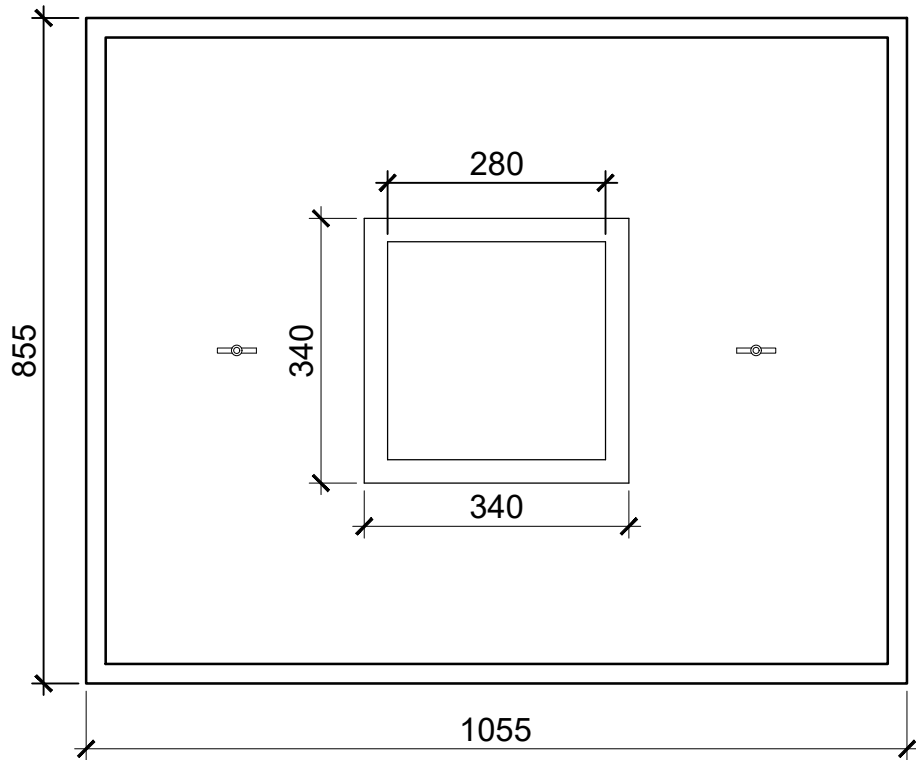
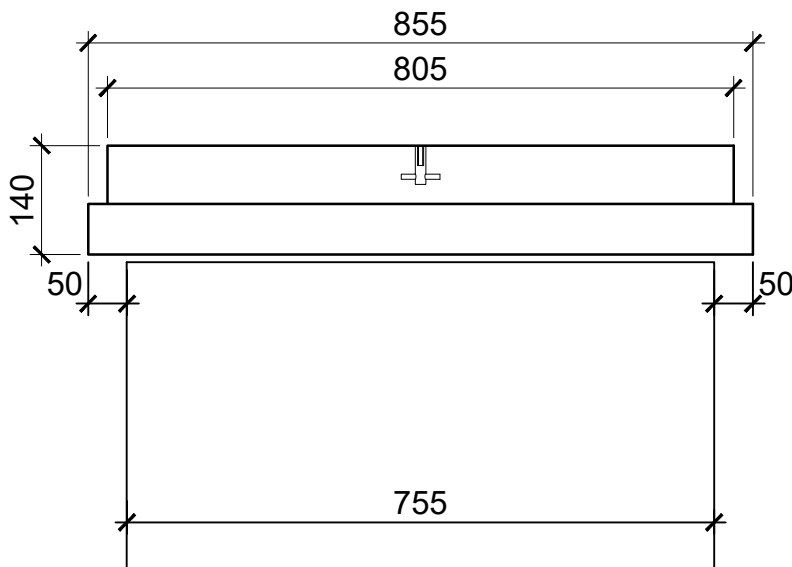
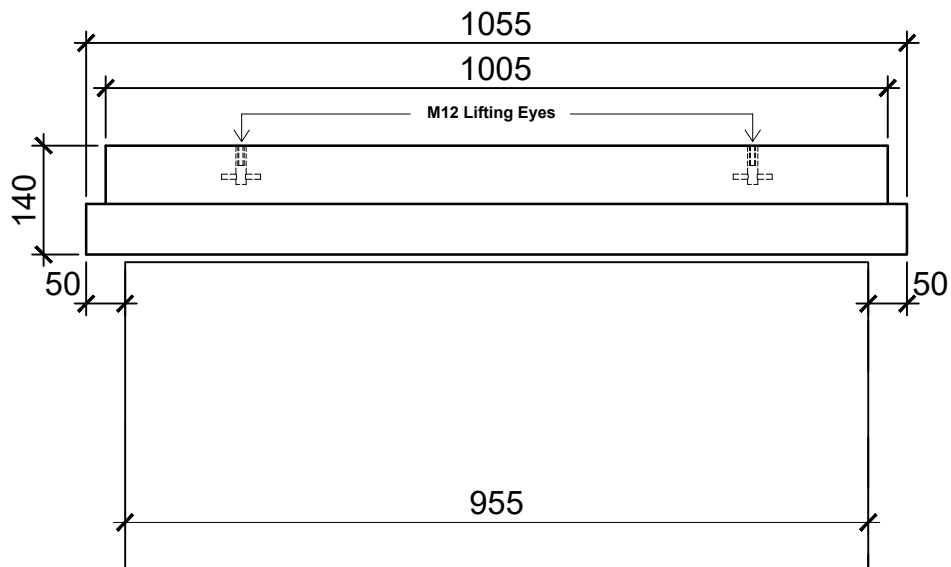

Section.

Plan View .
Unit Ref: B22UT25068 (230kg)

Rev	Date	Comments
A	27-05-21	Banding below capping removed.
B	15-06-21	Amended to revised stack size.
C	28-07-21	Amended to revised stack size.
D	28-09-21	Amended to revised stack size.
E	01-10-21	Size of hole through cap increased.

Tel : 01302 729277

Fax : 01302 729288

www.penninestone.co.uk

PENNINE

STONE LIMITED

A HADDONSTONE Group Company

Site Details		
THAMES & NEWCASTLE LTD.		
16 Roehampton Gate, London.		
Drg Title		
Bespoke Chimney Capping.		
Product: TecCast.		
Date:	16/02/21	Drg No.
Scale:	NTS	25068-10
Drawn By:	M. Brakewell	Rev. E